



DP579 Dolby E Tri-Level Sync Interface



The Dolby DP579 facilitates the use of high-quality Dolby E bitstreams on 24-frame systems.

The DP579 Dolby® E Tri-Level Sync Interface allows high-quality Dolby E multichannel audio and metadata to be stored on 24-frame systems using existing DP571 and DP572 Dolby E encoders and decoders. Applications include postproduction for DTV, electronic cinema, telecine, and archiving.

The DP579 converts tri-level video sync into Dolby Black, a video reference signal specifically for use with existing Dolby E equipment. The DP579 enables a pair of Dolby E codecs (DP571 Dolby E Encoder/DP572 Dolby E Decoder) to operate at 23.98, 24, and 30 fps from a tri-level reference, in addition to 25 and 29.97 fps. The DP579 also accepts traditional NTSC and PAL reference signals and passes them through unchanged.

Its convenient half-rack width allows a single DP579 to be installed alongside (or behind) existing DP571 and DP572 units. For standard rack mounting, the Dolby Cat. No. 546 rackmount kit (shown with the DP579 above) is available and will accommodate either one or two units.

DP579 Dolby E Tri-Level Sync Interface

DP579 Front Panel

Status LEDs

Indicate presence of power, tri-level and composite video reference, fault, and error

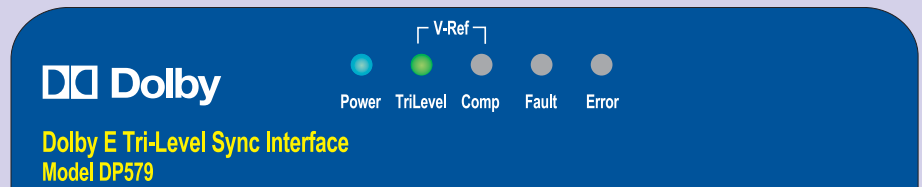

DP579 Rear Panel

Video Reference Input

BNC female connectors with loop-through, SMPTE 170M, SMPTE 274M, SMPTE 318M, SMPTE RP 154, external 75Ω termination required

Dolby Black Outputs

Two BNC female connectors, per SMPTE RP 154, SMPTE 318M

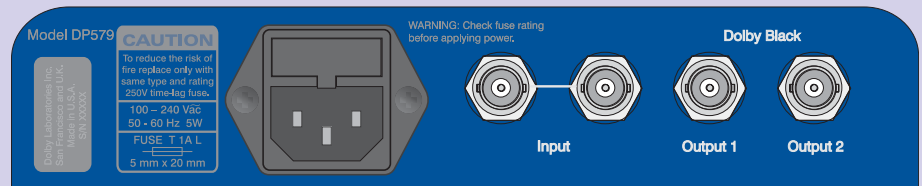

Supported Video Reference Formats

23.98, 24, 25, 29.97, 30 fps tri-level sync, per SMPTE 274M

23.98, 24 fps Sony PsF

24, 25 fps PAL program or black

29.97 fps NTSC program or black

Power Requirements

90–264 VAC, 50–60 Hz via internal supply, 5 W; this unit is designed to operate from a centrally switched power source

Dimensions and Weight

200 × 120 × 40 mm (7.9 × 4.7 × 1.6 inches)

Net: 0.7 kg (1.5 lb)

Environmental Conditions

Operating: 0°C–50°C (32°F–122°F), natural convection cooling

0%–98% relative humidity (noncondensing)

Nonoperating: –20°C to 70°C (–68°F to 158°F)

Regulatory Notices

North America: This unit complies with the limits for a Class A digital device pursuant to Part 15 of the FCC rules and Industry Canada ICES-003 Class A requirements. It is UL Listed for the US and Canada.

Europe: This unit complies with the requirements of Low Voltage Directive 73/23/EEC and EMC Directive 89/336/EEC and carries the CE marking accordingly.

Warranty

One-year limited, parts and labor; see disclaimer. Specifications subject to change without notice.

Disclaimer of Warranties

Equipment manufactured by Dolby Laboratories is warranted against defects in materials and workmanship for a period of one year from the date of purchase. There are no other express or implied warranties and no warranty of merchantability or fitness for a particular purpose, or of noninfringement of third-party rights (including, but not limited to, copyright and patent rights).

Limitation of Liability

It is understood and agreed that Dolby Laboratories' liability whether in contract, in tort, under any warranty, in negligence, or otherwise shall not exceed the cost of repair or replacement of the defective components or accused infringing devices, and under no circumstances shall Dolby Laboratories be liable for incidental, special, direct, indirect, or consequential damages (including, but not limited to, damage to software or recorded audio or visual material), cost of defense, or loss of use, revenue, or profit, even if Dolby Laboratories or its agents have been advised, orally or in writing, of the possibility of such damages.

Dolby and the double-D symbol are registered trademarks of Dolby Laboratories.

© 2005 Dolby Laboratories, Inc. All rights reserved. S05/15274/16137 Part No. 91765, Issue 3